

# 4G Pet GPS Tracker



## Tracking App installation

Use the guardian's mobile phone to scan below QR code and install the tracking App.



## SIM card installation

Please prepare a 4G network Nano card with 30 MB traffic. Open the SIM slot with screw driver in accessories. **Please make sure the tracker is power off, then insert the SIM card based on the direction as bellow picture shows till the SIM locked.** Charge it for 2 hours after inserting the SIM card. The device will automatically turn on when charging.

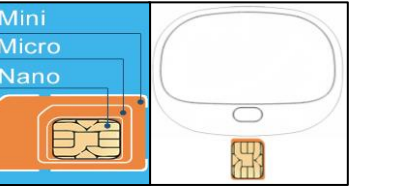

## Booting and Power off

Press the power key till the tracker beeps once, the sensor lights & indicators on.

Then it will search the network, the indicators will flash according to different working situations.

**Turn off the tracker via App only if it shows online in App; If it shows offline or no SIM card inside, press the power key till it beeps and light flash 2 times to power off.**

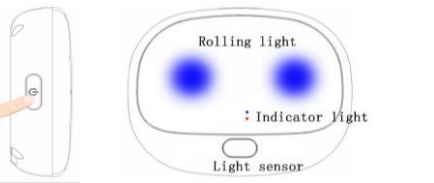

## Indicator instruction

	Color	Status	Meaning
Power on	Red (Network)	Slow flash	Signal searching
		Fast flash	Signal received
Power on	Blue (GPS)	Slow flash	Positioning
		Fast flash	Position uploaded
Charging	Red indicator	Slow flash	In charging
		Always on	Fully charged
	Blue indicator	Slow flash	In charging
		Slow flash	Fully charged

**Low battery: the red indicator slow flash only**

## App Login:

Login the App via device 10 digits ID number on back label and default password **123456** from the access of "Device ID" as screenshot shows.

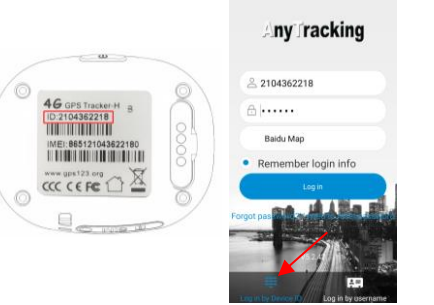

## Realtime Tracking:

App main page shows **Stationary** or **Moving** both means pet tracker is online.

Click **Real time tracking** icon to check the latest pet tracker location. Click the upper right corner icon to set location uploading intervals. The shorter interval is, the shorter standby time will be. So usually, we suggest to set "12 hours battery saving mode" to make sure pet tracker has a longer standby time.

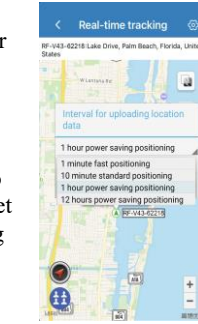

The tracker uploads the latest position once when the real time tracking page is opened.

## Historical route:

Display the historical route of any day in recent 90 days. You can choose whether to filter out LBS location data. (Note: LBS means the location data indoors, whose accuracy is not good.)

## GPS-fence:

Add, check or cancel GPS-fence. when the device gets into or out of the GPS-fence. The App will get an alert.



(Note: we suggest the radius of GPS-fence is over 300 meters to reduce false alerts.)

#### WIFI-fence:

At most to set 2 WIFI safe zones. Once the device leaves a WIFI safe zone, the App will get an alert.

**Health:** Check your pet's health status, including steps and energy consumption.

#### Talk:

- 1) Call to tracker: To call your pet tracker when click it;
- 2) Voice monitoring: To request a one-way



call from tracker to the number you type to hear the sound around the tracker.

#### Settings:

**Only when App is online can user make settings.**

#### About the device:

#### Contact number:

Please make sure to fill in the guardian's number for App password reset in later use.

**Filter LBS and WIFI:** As these two tracking ways' accuracies are poorer, user can choose to filter either of them in daily use. If the pet stays indoors usually, either of them is not recommended to choose in case



the location stops updating. Click Save icon after editing.

#### Main monitoring number & Set SOS number:

Since the V43 has no 2 ways communication, it is no need to set either these two settings.

**SMS alert switch:** SMS alert has canceled in new version to save the SMS cost.

**Sensor light:** Turn on/ off the sensor lights on tracker, to enable them to be on automatically in darkness surroundings, which makes the tracker easier to be found.

(This function will affect the device standby time, please use it when it is needed.)

**Signal light:** Turn on or off the signal indicator lights on tracker;

**Safe mode:** The tracker has no 2-way communication, so no need set the function.

**Find your pet:** When activate this function, the tracker will send out ringtone for being found easily.

#### Device Language and time zone:

The tracker has SMS alerts only in English and it adjusts the time zone automatically.

**Remote reboot:** To reboot the tracker from this setting remotely.

**Remote power-off:** To power off the tracker remotely.

**Factory-Reset:** To default the device back to factory settings. It will delete all data.

**To know more, please login web platform: [www.gps123.org](http://www.gps123.org).**

#### Main features list:

- 4G LTE+2G GSM networks
- Waterproof IP67
- LED rolling lights turn on automatically
- GPS positioning, with accuracy of 5m outdoor
- WIFI positioning, with accuracy of 30m indoors
- Web platform/ App/ SMS for positions check
- Historical route
- Geofence: GPS fence & WIFI fence double care
- Step counting
- Voice monitor and Ringtone to find pet
- Low battery alarm

#### Packing list

- |                  |                         |
|------------------|-------------------------|
| 1* GPS tracker   | 1* USB charging cable   |
| 1* Screw driver  | 1* User manual          |
| 2* Spare screws  | 1* Sim Card Ejector Pin |
| 1* Silicone case |                         |

#### Product specification:

##### Version A

4G FDD: Band 1/3/5/7/8/20  
4G TDD: Band 38/39/40/41  
2G GSM: Band 2/3/5/8

##### Version B

4G FDD: Band 2/4/5/7/12/28  
2G GSM: Band 2/3/5/8

**GPS accuracy:** 5-15m (In open sky)

**WIFI accuracy:** 15-100m (Under WIFI signal coverage)

**Working temperature:** -20°C ~ +70°C

**Working humidity:** 5% ~ 95% RH

**Host size:** 52\*42\*15mm

**Device net weight:** 35g

**Battery capacity:** 500mA

#### Important! Please read below statements:

1. Due to external factors, all GPS devices have position error, so the position provided by this device is just for reference.
2. There may be delays caused by telecom operators at certain circumstance. Our company doesn't assume to take responsibility of loss causes by this delay.

#### Q: The SIM card has 4G data plan, but the device still shows "Not enabled" or "offline" in App.

A: Check whether the SIM card in tracker is activated with GPRS data plan.

Make sure the tracker is powered off when installing a SIM card.

B: Some SIM cards need to configure APN for tracker using its data. Find out your tracker SIM card's APN name, APN user name, password, MCC and MNC codes before doing below settings. Please send below text to tracker SIM card number to

configure APN into the tracker. The command is:

`pw,123456,apn,apndata,user,password,MCC MNC code#`

(Note: The yellow parts are different for different SIM providers. If user and password are blank, delete them from the command, but keep the comma. There is no space between them and all letters shall be in lowercase style. For example, APN: mobiledata; Username and Password are blank, MCC: 204; MNC: 04. The command should be:

`pw,123456,apn,mobiledata,,20404#`)

#### Q: Sometimes, WIFI fence has no alarm?

The WIFI in this tracker doesn't support 5G WIFI. Android phones shall choose 2.4G WIFI as the hotspot of WIFI fence.

iPhones uses the phone connecting WIFI as the fence hotspot automatically. If your iPhone is connecting a 5G WIFI, please don't set WIFI fence to avoid the situation of no WIFI fence alarms.